

## SUMMARY PAGE

### GENERAL

Applicant: Franzia Properties, LLC  
Location: 675 66<sup>th</sup> Avenue  
Acreage: ±16.9 acres  
Land Use Designation: L-2, Low-Density Residential-2 (up to 6 units/ac.)  
Existing Zoning: A-1, Agricultural District (up to 1 unit/5 acre)  
Requested Zoning: RS-6, Single-Family Residential District (up to 6 units/acre)  
Existing Land Use: Vacant/pasture land (former citrus grove)

### ADJACENT LAND

North: 8<sup>th</sup> Street, Sub-Lateral B-3-W Canal, A-1, Agricultural District (up to 1 unit/5 acre)  
South: RS-6, Single-Family Residential District (up to 6 units/acre)  
East: RS-3, Single-Family Residential District (up to 3 units/acre)  
West: 66<sup>th</sup> Avenue, A-1, Agricultural District (up to 1 unit/5 acre)

### INFRASTRUCTURE

Potable water and wastewater service is available

### ENVIRONMENTAL CONSTRAINTS

None

### PUBLIC NOTIFICATION

	Planning and Zoning Commission	Board of County Commissioners
Staff Contact:	Bill Schutt	Bill Schutt
Date Advertised:	11/28/18	1/6/19
# of Surrounding Property Owner Notifications:	33	38
Date Notification Mailed:	11/28/18	1/7/19
Date Sign Posted:	11/28/18	1/7/19

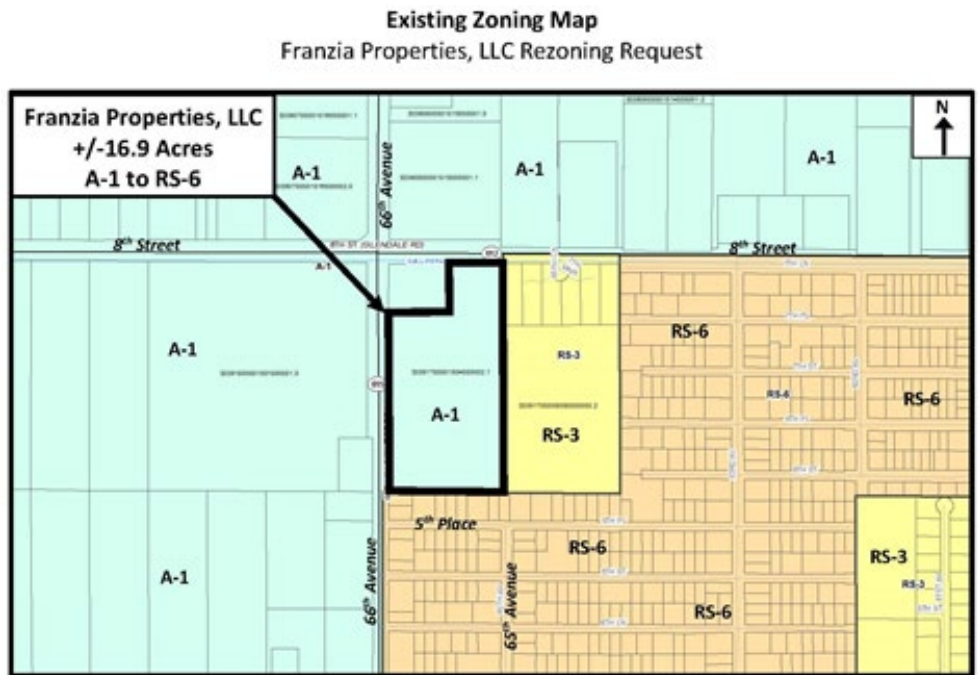

### STAFF RECOMMENDATION

Approval

## ATTACHMENT 1