

**PROPOSED WATER ASSESSMENT PROJECT LOCATION MAP  
WINTER BEACH HIGHLANDS SUB & A PORTION OF WINTER BEACH PARK  
51ST AVENUE FROM 65TH ST - 69TH ST**

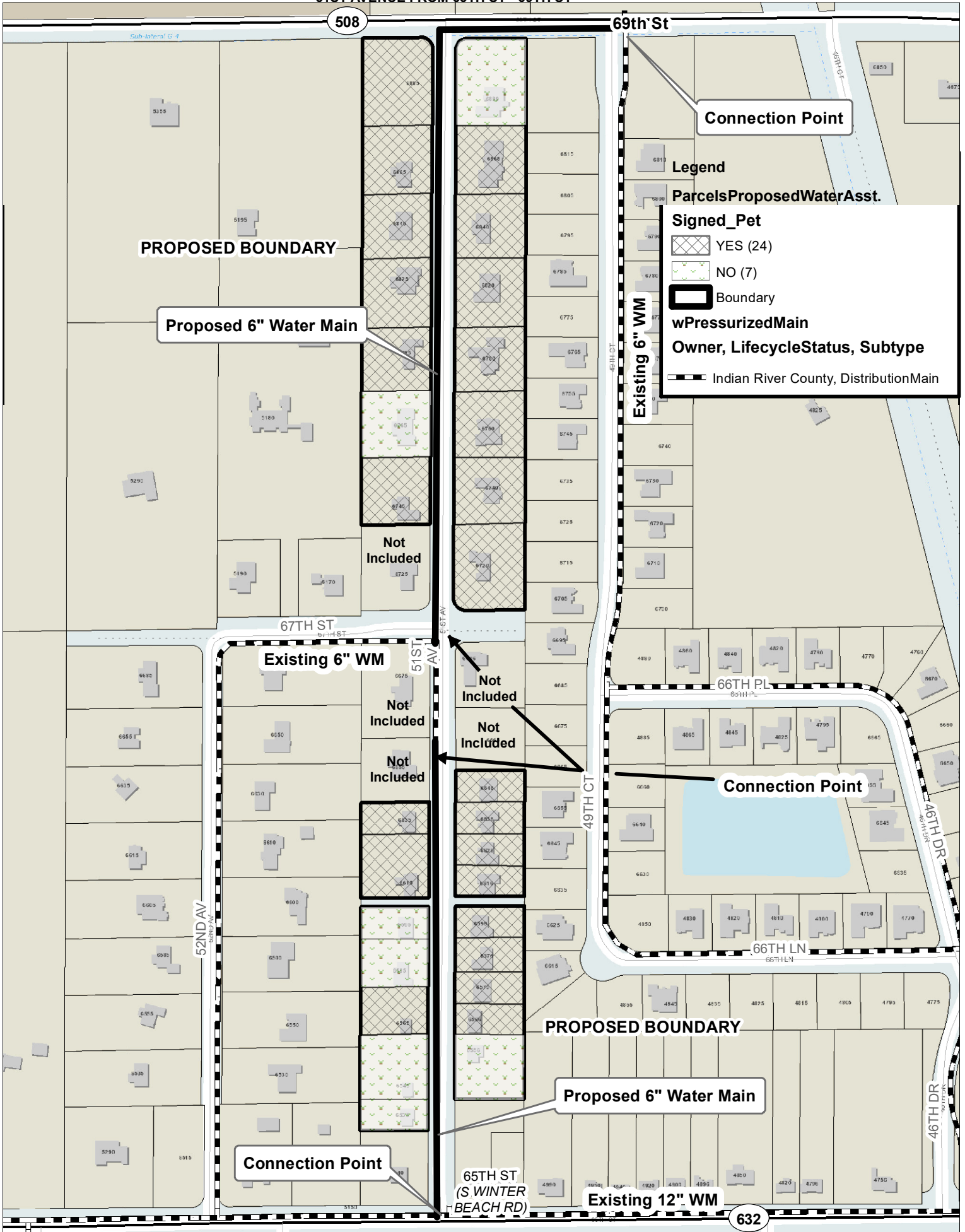

PROPOSED BOUNDARY

Proposed 6" Water Main

Connection Point

Legend

Parcels Proposed Water Asst.

Signed\_Pet

YES (24)

NO (7)

Boundary

wPressurizedMain

Owner, LifecycleStatus, Subtype

Indian River County, DistributionMain

Not Included

Existing 6" WM

Not Included

Not Included

Not Included

Connection Point

PROPOSED BOUNDARY

Proposed 6" Water Main

Connection Point

65TH ST (S WINTER BEACH RD)

Existing 12" WM

632