

GENERAL NOTES:

SCOPE OF WORK:

THE WORK, AS DEFINED IN THE DRAWINGS AND THE TECHNICAL AND NON-TECHNICAL SPECIFICATIONS INCLUDES BUT IS NOT NECESSARILY LIMITED TO THE FOLLOWING:

1. **BASE BID:**
LIMITED DEMOLITION WORK FOR THE EXISTING WOOD PIER INCLUDING FRAMING REPAIR, DECKING REPLACEMENT, NEW RAILING, POLE MOUNTED LIGHTING AND FIRE PROTECTION.
2. **ALTERNATE #1:**
PROVIDE SYNTHETIC DECKING IN LIEU OF WOOD DECKING FOR THE REPLACEMENT DECKING AT THE EXISTING PIER.
3. **ALTERNATE #2:**
PROVIDE NEW PILES AND SUPPORT FRAMING FOR THE ICE HOUSE.
4. **ALTERNATE #3:**
PROVIDE ALL WORK REQUIRED TO FURNISH AND INSTALL THE COMPLETE WOOD DECK AT THE EAST SIDE OF THE FISH HOUSE INCLUDING PILES, FRAMING, DECKING, LIGHTING AND RAILINGS. PROVIDE SEPARATE PRICES FOR BOTH WOOD AND SYNTHETIC DECKING.
5. **ALTERNATE #4:**
PROVIDE ALL WORK REQUIRED TO FURNISH AND INSTALL THE COMPLETE WOOD RAMP AND LANDINGS INCLUDING PILES, FRAMING, DECKING, RAILINGS AND HANDRAILS AS WELL AS THE FLOATING DOCK WITH VARIABLE RAMP. PROVIDE SEPARATE PRICES FOR BOTH WOOD AND SYNTHETIC DECKING.
6. **ALTERNATE #5:**
PROVIDE ALL WORK REQUIRED TO FURNISH AND INSTALL THE COMPLETE WOOD FIXED BOAT DOCKS INCLUDING PILES, FRAMING, DECKING, RAILINGS, CLEAR, AND DOCK SUPPORTS. PROVIDE SEPARATE PRICES FOR BOTH WOOD AND SYNTHETIC DECKING.

CONTRACTOR RESPONSIBILITY:

1. ALL WORK TO COMPLY WITH APPLICABLE CODES. THE CONTRACTOR MUST COMPLY WITH THE RULES AND REGULATIONS OF AGENCIES HAVING JURISDICTION AND TO COMPLY TO ALL CITY, COUNTY, STATE AND FEDERAL, CONSTRUCTION SAFETY AND SANITARY LAWS, CODES, STATUTES AND ORDINANCES.
2. ALL FEES, TAXES, PERMITS, APPLICATIONS AND CERTIFICATES OF INSPECTION AND THE FILING OF ALL WORK WITH GOVERNMENTAL AGENCIES TO BE THE RESPONSIBILITY OF THE CONTRACTOR. CONTRACTOR TO OBTAIN ALL PERMITS AND APPROVALS PRIOR TO COMMENCEMENT WITH THE WORK.
3. ALL WORK SHALL BE PERFORMED BY SKILLED AND QUALIFIED WORKMEN IN ACCORDANCE WITH THE BEST PRACTICES OF THE TRADES INVOLVED AND IN COMPLIANCE WITH BUILDING REGULATIONS AND/OR GOVERNMENT LAWS, STATUTES OR ORDINANCES CONCERNING THE USE OF UNION LABOR.
4. CONTRACTOR AND SUB-CONTRACTORS TO FIELD VERIFY ALL DIMENSIONS AND CONDITIONS SHOWN ON DOCUMENTS AND MUST NOTIFY ARCHITECT OF ANY DISCREPANCIES, OMISSIONS AND/OR CONFLICTS PRIOR TO PROCEEDING WITH THE WORK.
5. EACH TRADE WILL BE EXPECTED TO PROCEED IN A MANNER THAT WILL NOT DELAY OTHER TRADES.
6. THE CONTRACTOR IS RESPONSIBLE FOR THE DISTRIBUTION OF DRAWINGS TO ALL TRADES UNDER THEIR JURISDICTION.
7. ALL MATERIALS TO BE NEW UNLESS AND OF THE HIGHEST QUALITY IN EVERY RESPECT, UNLESS OTHERWISE NOTED. MANUFACTURED MATERIALS AND EQUIPMENT TO BE STORED AND INSTALLED IN ACCORDANCE WITH THE MANUFACTURER'S WRITTEN RECOMMENDATIONS AND INSTRUCTIONS.
8. WHERE A MANUFACTURER IS SPECIFIED AND "EQUAL TO" OR "APPROVED EQUAL" ARE USED, ARCHITECT/ENGINEER TO DETERMINE EQUALITY BASED ON INFORMATION SUBMITTED BY THE CONTRACTOR.
9. ALL WORK AND MATERIALS TO BE GUARANTEED AGAINST DEFECTS FOR A PERIOD OF NOT LESS THAN ONE (1) YEAR AFTER APPROVAL OF FINAL PAYMENT. FOR EQUIPMENT, PROVIDE HANDBOOK AND WARRANTY/REGISTRATION INFORMATION TO OWNER UPON PROJECT COMPLETION.
10. THE CONTRACTOR IS RESPONSIBLE FOR CUTTING AND PATCHING REQUIRED FOR HIS WORK UNLESS OTHERWISE NOTED.
11. THE CONTRACTOR SHALL, AT ALL TIMES, KEEP THE PREMISES FREE OF ACCUMULATION OF WASTE MATERIALS OR RUBBISH. PREMISES TO BE KEPT CLEAN DAILY.
12. THE CONTRACTOR TO PROVIDE FINAL CLEANING OF ALL AREAS OF WORK INCLUDING THE CONSTRUCTION ACCESS ROUTE.
13. DO NOT SCALE DRAWINGS! DIMENSIONS GOVERN. LARGER SCALE DRAWINGS TO GOVERN OVER SMALLER SCALE DRAWINGS.
14. IF DIMENSIONS ARE IN QUESTION, THE CONTRACTOR IS RESPONSIBLE TO GET CLARIFICATION AND DIRECTION FROM ARCHITECT PRIOR TO PROCEEDING WITH THE WORK.
15. ALL INSTALLED PUMPING AND ELECTRICAL EQUIPMENT TO OPERATE QUIETLY AND BE FREE OF VIBRATION.
16. UPON COMPLETION OF THE WORK, THE CONTRACTOR TO NOTIFY BUILDING OWNER REPRESENTATIVE THAT THE PROJECT IS READY FOR INSPECTION. OWNER REPRESENTATIVE TO COMPLETE A PUNCH LIST OF CORRECTIONS NEEDED. IF UNSATISFACTORY AND/OR INCOMPLETE WORK, FINAL PAYMENT WILL BE CONTINGENT UPON THE SUCCESSFUL COMPLETION OF THE PUNCH LIST.
17. ALL WORK TO BE SCHEDULED DURING REGULAR BUSINESS HOURS UNLESS NOTED OTHERWISE.
18. ALL WORK SHALL BE IN ACCORDANCE WITH THE 2014 EDITION, AND RELATED SUPPLEMENTS, OF THE (FBC) FLORIDA BUILDING CODE AS ADOPTED BY LOCAL REGULATIONS.
19. VERIFY ALL DIMENSIONS AND SITE CONDITIONS PRIOR TO THE START OF CONSTRUCTION. NOTIFY THE ARCHITECT/ENGINEER OF ANY DISCREPANCIES OR INCONSISTENCIES PRIOR TO BID.

20. DESIGN INFORMATION SHOWN ON THE DRAWINGS PROVIDE OVERALL DIMENSIONAL PARAMETERS AND DESCRIBE ELEMENTS TO BE CONSTRUCTED. THE CONTRACTOR SHALL ADJUST DIMENSIONS AND DETAILS AS REQUIRED TO FIT EXISTING CONDITIONS. THE ARCHITECT/ENGINEER SHALL BE NOTIFIED OF ANY PROPOSED MODIFICATIONS PRIOR TO CONSTRUCTION.
21. IF REQUIRED, DEMOLITION SHALL INCLUDE, REMOVAL, TRANSPORT, AND DISPOSAL OF ALL WASTE MATERIAL RELATED TO THE CONSTRUCTION OF THE PROJECT TO AN APPROVED DISPOSAL FACILITY IN STRICT ADHERENCE WITH APPLICABLE STATUTES, ORDINANCES, AND POLICIES.
22. AT START OF CONSTRUCTION, THE CONTRACTOR SHALL SECURE ONE FULL SIZE SET OF THE FINAL CONSTRUCTION / PERMIT CONSTRUCTION DOCUMENTS TO BE MAINTAINED IN A CLEAN CONDITION AT THE PROJECT SITE.
23. CONTRACTOR IS RESPONSIBLE FOR KEEPING CONSTRUCTION AREA CLEAN AND FREE FROM DEBRIS ON A DAILY BASIS. ALL DEBRIS SHALL BE REMOVED AND DISPOSED PER LOCAL / APPROVED DISPOSAL REQUIREMENTS.
24. CONTRACTOR TO PROVIDE ALL METAL CONNECTIONS TO PREVENT ELECTRICAL RISK / CORROSION OF DISSIMILAR METALS. STAINLESS STEEL CONNECTIONS WITH METAL FILM DAMAGED DURING INSTALLATION SHOULD NOT BE USED TO PREVENT STAINLESS STEEL FROM BECOMING "ACTIVE" WHEN USING GALVANIZED CONNECTIONS. PROVIDE GALVANIZED TOUCH UP NECESSARY TO MAINTAIN METAL PERFORMANCE. UNLESS NOTED OTHERWISE, PROVIDE ALL EQUIPMENT NUT TO BOLT CONNECTIONS WITH A SYNTHETIC RUBBER COATING. AFTER FINAL TIGHTENING OF CONNECTIONS OR PRIOR TO CONSTRUCTION COMPLETION.

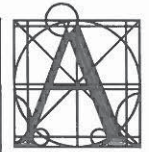
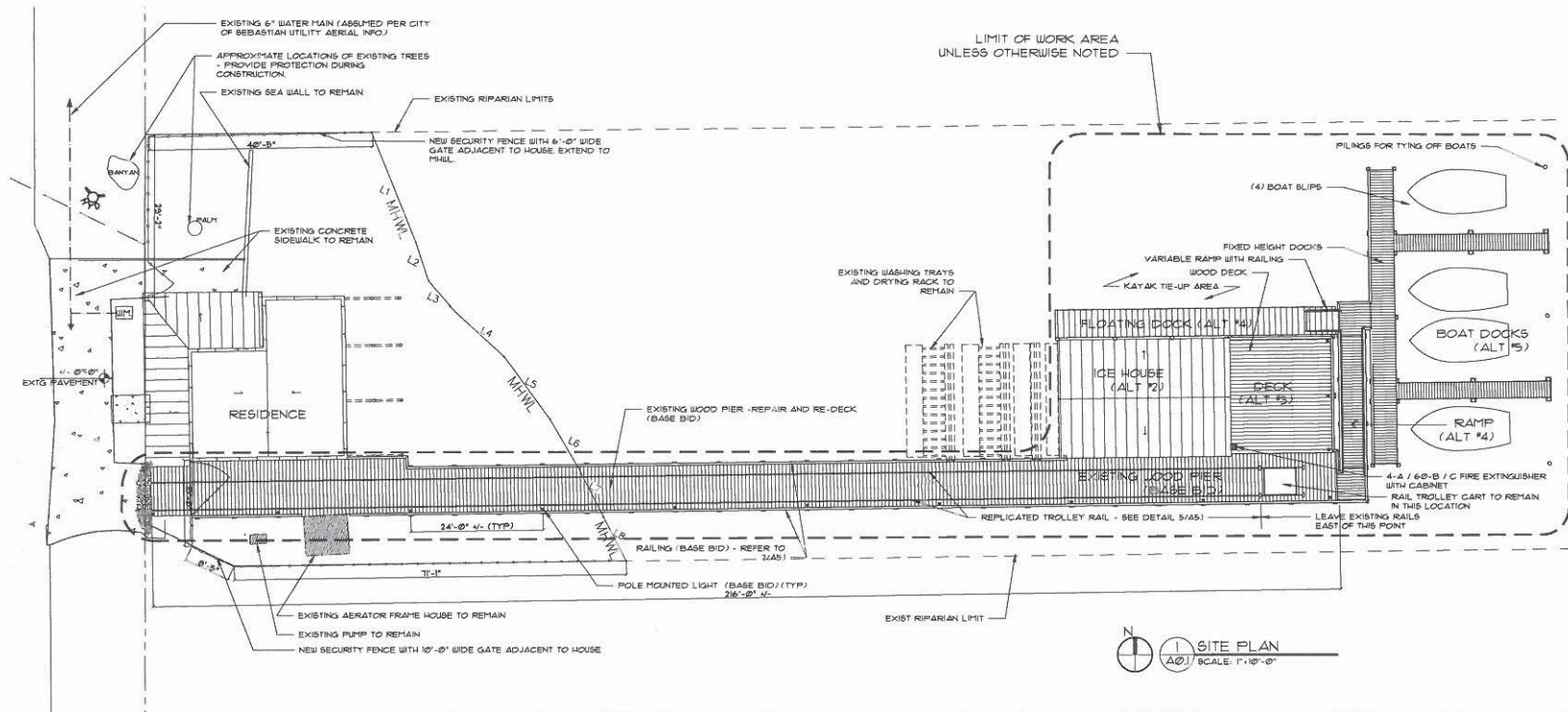

ATELIER
ARCHITECTURE
ENGINEERING
CONSTRUCTION
INCORPORATED
2719 S. Main Hill Av.
Tampa, Florida 33602 (813)831-3223
Florida Registration - AA 0002431

Site Plan - Existing / Proposed
ARCHIE SMITH FISH HOUSE RESTORATION
Sebastian, Florida

Srnl
John L. Terveno, AIA
AR000789

Date
03-01-16
Drawn: MH
Checked: JT

BID SET

Revisions:

Project No.
1406
Sheet No.
A-1.0